

SPRINGFIELD SCHOOL



Newsletter 16

29th January 2021

Message from the Headteacher

Dear Parents and Carers,

I am writing to update you on school's position in relation to opening after the half term break. After the initial Governments announcement at the beginning of January we reduced pupil and staff numbers on site to ensure our community remained safe taking into consideration the lack of social distancing, high staff ratios and the size of the school and it's staff in total.

We have been working with the Local Authority to support us to open for more pupils with a view of Special School staff being in a priority group for the vaccine. A vaccine rollout programme has been confirmed for staff this week and will commence prior to the half term break. The vaccine will offer a further layer of protection for our school community, although we still need to adhere to the safety measures we had in place prior to Christmas.

With this in mind after half term we invite all pupils back into school where parents feel this is right for their child. We must not underestimate the continued pandemic, and the risks the school environment can bring however, we do appreciate that home learning is not always beneficial for all of our pupils, we recognise a lack of structure and routine can be difficult for all of our families. Pupils will remain in their original bubbles, there will be no off-site activities, physical Education or Forest Schools during the lockdown however, we will be offering swimming to pupils every other week.

I do appreciate this will be difficult decision for many parents, and unfortunately it is a decision that you need to make as a family. We have in place a number of safety measures to support the prevention of the spread of COVID, but these measures will not eradicate it from school completely, all our safety measures are outlined with the risk assessment on the website. We will support all parents who wish their children to come in school (this will be on a full-time basis only) but equally we will support those parents who wish for their children to remain at home. There will be no fines issued for children whose parents wish them to remain at home.

We will be offering a programme of remote learning; however, this may not look exactly like it has during this first half term as all teachers will be back in school on a full-time basis.

Please complete the form sent by text to let us know if you require a full-time place after half term.

Please do not hesitate to get in contact if you have any questions.

Kind Regards

L Hodgkison

Lisa Hodgkison

Headteacher

News and Information

EfL Update

In order for us to get notifications about what you've uploaded on EfL, we have had to turn on the 'Parent Feedback' option. This means when you log in, you will be able to see Feedback along the top bar. ***Please do not use this feature as the messages will not be regularly monitored.*** We will continue to welcome feedback through eSchools, email and phone calls as always.

Did you know to make it easier to get to your log in screen, you can create a direct link to this from your iPad, tablet or phone home screen?

1. Load the website from the link sent to you by email
2. On an Apple device click the share icon (square with arrow pointing upwards), on an Android device click the + symbol
3. Click add to home screen
4. You will now have an icon resembling the log in screen In future, just click that and it will take you directly to the log in screen.

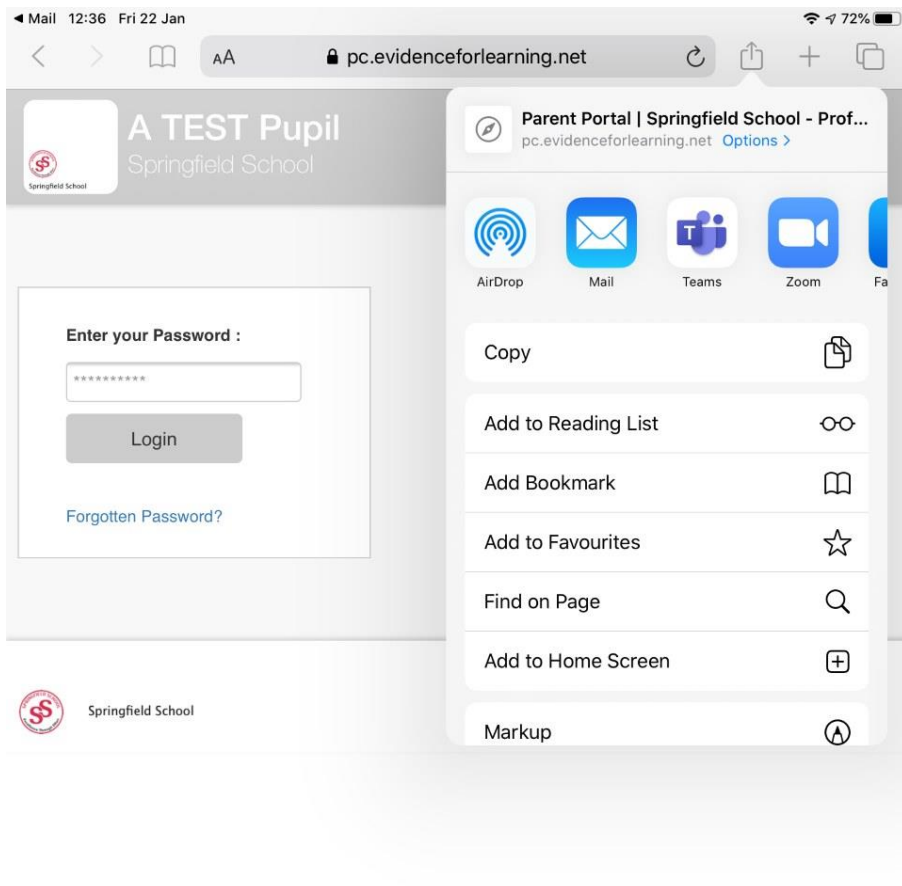

Mail 12:36 Fri 22 Jan

pc.evidenceforlearning.net

72%



A TEST Pupil

Springfield School

Enter your Password :

Login

[Forgotten Password?](#)



Springfield School

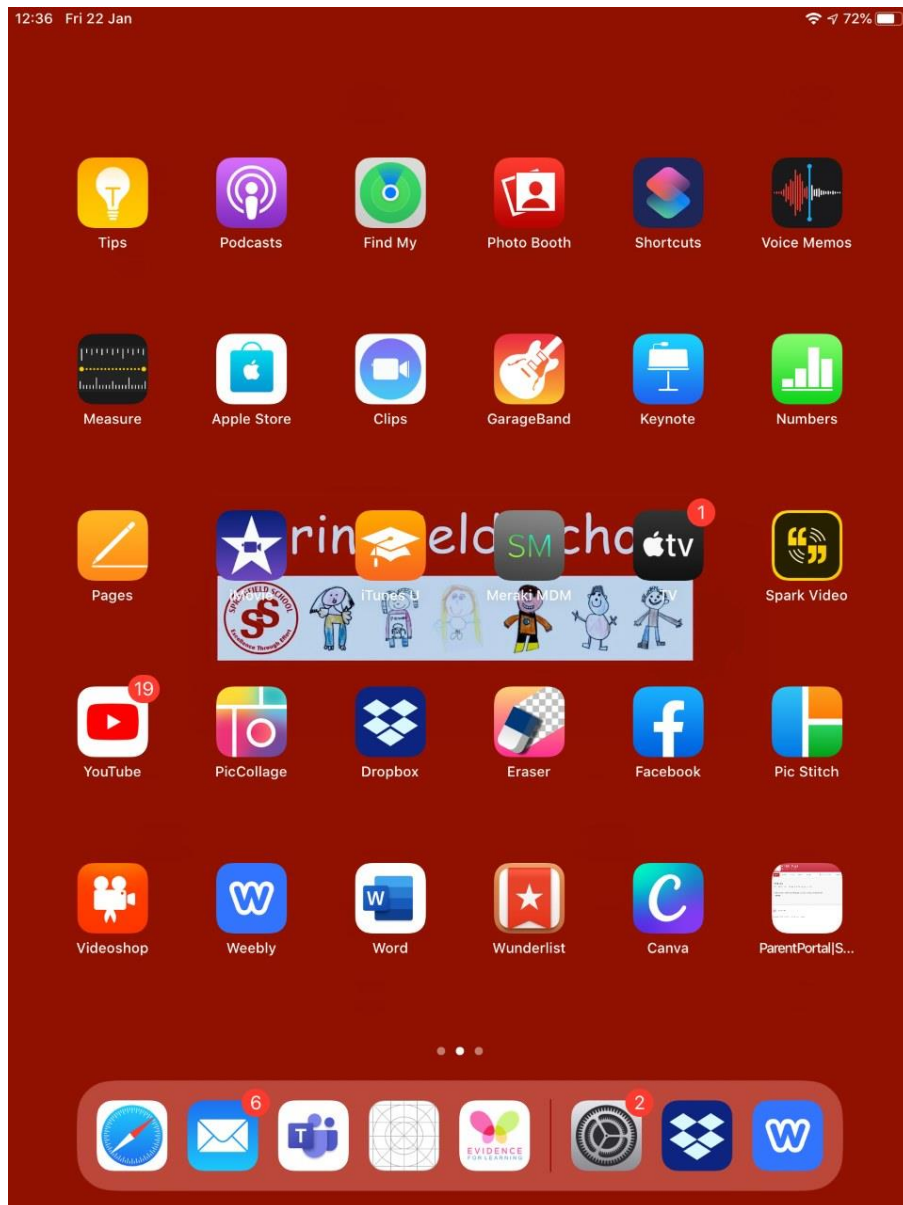

Children's Mental Health Week

Next week, 1st - 7th February 2021, is Children's Mental Health Week, which is particularly relevant in the current circumstances. The theme this year is 'Express Yourself', finding ways to help and encourage children to share their feelings and throughout the week children will be taking part in some activities around this, at school or as home learning.

There is more information on the [Place2Be](#) and the [Mind](#) websites.

0-25 Cheshire East Local Offer for Special Educational Needs and Disability (SEND)

For any parents who are not aware of the Cheshire East Local Offer, take a look at this link: [Things to do - Cheshire East](#) where you will find information about specialist leisure activities that have been specifically tailored for children and young people aged 0-25 with Special Educational Needs and/or Disabilities (SEND). On the website, they detail all activities and services available to young people with SEND. They might not all currently be running because of COVID-19 but we just wanted to share this with you so you can look at options that might be suitable for your son/daughter outside

of school in the coming months. You can filter the results by age, location or interests so you may well find something perfect for your son/daughter.

We need your help so that people with a learning disability get priority for the coronavirus vaccine



Despite the fact that people with a learning disability are more than six times as likely to die from coronavirus as the general population, many people with a learning disability are not in any of the priority groups that will get a potentially life-saving vaccine soon.

This is unfair and puts lives at risk. We need your help to change this.

We are at an important time with the fight against the pandemic, but there is hope as the new vaccine is rolled out. Having a coronavirus vaccine is the best way to protect you, and the people around you, from coronavirus.

Some people are getting priority for having the vaccine. For example, priority group 6 includes people with a severe or profound learning disability – but not everyone with a learning disability is included.

Health in Wales is devolved to the Welsh Government. If you live in Wales, you can take action by signing a petition to the Senedd Cymru, calling for all people with learning disabilities in Wales to be made a higher priority. [Sign the petition to the Senedd Cymru today](#).

If you live in England, please can you email your MP and ask for all people with a learning disability to be included in at least group 6?

[Email your MP](#)

It is really quick and easy to get in touch with your MP using this link - it will only take five minutes.

Share your story with your MP

If you have a learning disability, or care for someone who does, your MP needs to hear from you.

Share your experience and ask your MP to write to Matt Hancock, Secretary of State for Health and Social Care, and call for all people with a learning disability to be a priority for the vaccine

[Contact your MP today](#)

Free School Meals

The Free School Meal Vouchers haven't been issued via Edenred. If you are eligible for the vouchers you will have received an email containing the code you need to redeem them. If you have not received an email or are having any difficulties, please contact us.

If your child is not currently receiving free school meals and you think you may be eligible to claim, please contact [Cheshire East Council](#).

Meanwhile, if you are struggling, please do not hesitate to contact us in school.

Weekly Inspiration

This week 2LW share a quote from Roald Dahl, The Minpins.

"And above all, watch with glittering eyes the whole world around you because the greatest secrets are always hidden in the most unlikely places. Those who don't believe in magic will never find it."

Lockdown Lunches and Meal Plans

Change4Life have created recipes and shopping lists for families which can be used to create lunches for around £15 each week. You will find these from the link below.

<https://www.nhs.uk/change4life/recipes/lunch/cheap-lockdown-lunch-ideas>

Reminders

NUT FREE SCHOOL

For new and existing parents please remember that we are a Nut Free School and be mindful of this when sending in snacks or packed lunches

DINNER MONEY

Current school meal prices are:

Primary aged pupil (year 3-6) - £2:30 per meal

Secondary aged pupil (year 7 and over) - £2:50 per meal

SPRINGFIELD SENSORY FACEBOOK PAGE

There is a private Facebook page for staff and parents called 'Springfield Sensory'. This group contains lots of resources which parents may find useful at home and which are suitable for all abilities. You can identify it by the logo shown.



Our NHS Team

Nursing Team

Could parents/carers let the Nursing Team know of any changes in their child's conditions/medications/ A & E attendances etc via eSchools to Jenny Smith, Katie Mulroy or Debbie Potts. Parents can e-school, send letters or call us. We are in school between 8.30am and 16.30pm each week day.

Direct phone numbers to the nursing team are:

01270 826151 there is an answerphone on this.

01270 826150 there is no answerphone on this.

The new number to call for any continence issues or change of size of nappies is 01270 826360.

Physiotherapy and Occupational Therapy

If you have any questions regarding your child's physio/OT/Orthotics care, the team can be contacted via eSchools, or telephoning school and asking for the Therapy Department. Could you please let us know of any upcoming orthopaedic appointments or planned surgery that has been scheduled for your child. Hayley Mitchell, Physiotherapist is in school Monday to Friday and Yvonne Williams, OT works on a Monday.

Useful contact numbers

For wheelchair reviews:

Physio/OT office: 01270 826153

Wheelchair assessment unit: 01625 663345

Wheelchair repairs: Rossicare 0151 6536000

Speech Therapy

We are always keen to hear from you - please feel free to contact us with any questions about your child's treatment.

Jo Currie is available Monday, Tuesday, Wednesday

Alex Makin is available Wednesday (pm), Thursday, Friday

Phone the school on 01270 685446 or on direct line 01270 826152.

Email: joanne.currie2@mcht.nhs.uk

alex.makin@mcht.nhs.uk

Or contact via eSchools

Contact Us

If you need to contact us :

Springfield School

Crewe Green Road

Crewe

CW1 5HS

Telephone: 01270 685446

Email: head@springfield.cheshire.sch.uk